

# DBD 0500-1

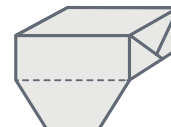

Soup Tablets  
Wrapping Machine

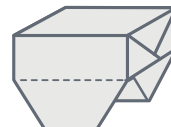
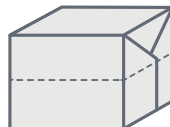
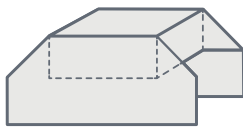

The DBD 0500-1 is the evolution of the DBD 0500 as it has now an integrated HMI to facilitate daily work. With the DBD 0500-1, Sapal offers today an upgraded single format machine with a twin wrapping head, three-side heat seal developed using the company's worldwide knowledge base and expertise and especially designed for the mid-range speed wrapping of soup tablets.

#### HIGH PRODUCT THICKNESS TOLERANCE

The DBD 0500-1 has the capability to accept a height product tolerance of 3mm (from 9 to 12 mm) without having to change the format parts.

#### ERGONOMIC: EASY TO USE AND TO MAINTAIN

The folding box is easily accessible and dismountable.  
The heat sealing channel is equipped with a pivoting cover.

#### RELIABILITY

Best results in harsh environments.

#### PERFECT FOLDING AND SEALING, STILL EASY TO OPEN

Folding type allowing an easy opening, while having a perfect sealing ensuring the freshness of the product.

#### CHOICE OF WRAPPING MATERIAL

Wrapping by folding box enables the use of flexible materials, such as aluminum/OPP laminations or OPP monofilm with sealing lacquer.

#### LOW OPERATING COSTS

The DBD 0500-1 doesn't consume any compressed air. The machine is able to cool the products after sealing if it is connected with a cooling water system, however it is not necessary with OPP films. Furthermore, due to its technology, the DBD 0500-1 requires only few wearing parts.

#### USER-FRIENDLY INTERFACE

The Human Machine Interface (HMI), a very easy to use touch panel, provides a tailored interface to operate the machine.

#### YOUR BENEFITS

- High product thickness tolerance
- Ergonomic: easy to use and to maintain
- Reliability
- Perfect folding and sealing, still easy to open
- Choice of wrapping material
- Low operating costs
- User-friendly Interface

## STANDARD FEATURES

- Completely enclosed
- Automatic lubrication of major driving parts
- Single motor drive
- Push button controls for the usual operation of the machine
- Speed variation during the operation
- Horizontal product infeed belt
- Single reel carrier with holder for spare reel
- Horizontal discharge with heaters
- Parts in contact with products made of stainless steel

## WRAPPING SEQUENCE

Tablet size wrapping sequence

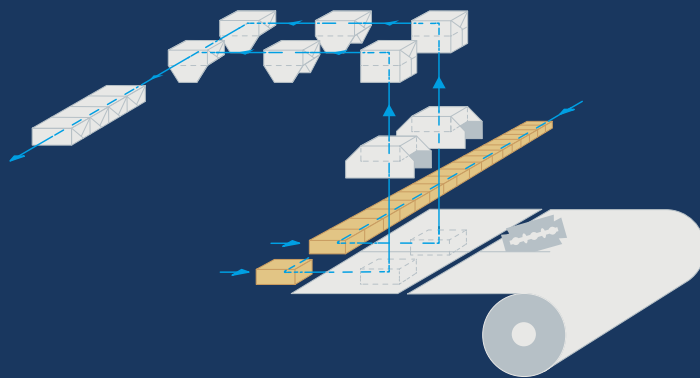

- OPTIONS**
- Wrapping material centering by photocell
  - Exit reversing device

## TECHNICAL SPECIFICATIONS

### Machine Footprint and Weight

Footprint 2042 x 1686 x 1830 mm

Weight 1500 kg

### Noise Level Equivalent Average

Leq moy 75 dB

### Standard Color

RAL 9006 (White Aluminium)

### Product Dimensions (single format)

#### Tablet size 1

Product L x W x H 29 x 24 x 9 to 12 mm

#### Tablet size 2

Product L x W x H 31 x 23 x 9 to 12 mm

### Wrapping Style

Portfolio wrapping by folding box type CH

### Wrapping Material

Outer reel diameter 350 mm

Inner reel diameter 70 mm

Maximum reel weight 8 kg

Material Paperbacked aluminium, OPP composite, or heat sealable OPP monofilm

### Capacity

Maximum output Up to 500 wraps/minute

### Electrical Specifications

Standard supply 400 V, 3-phase, neutral, ground

Frequency 50 Hz or 60 Hz

Power consumption 3 kW

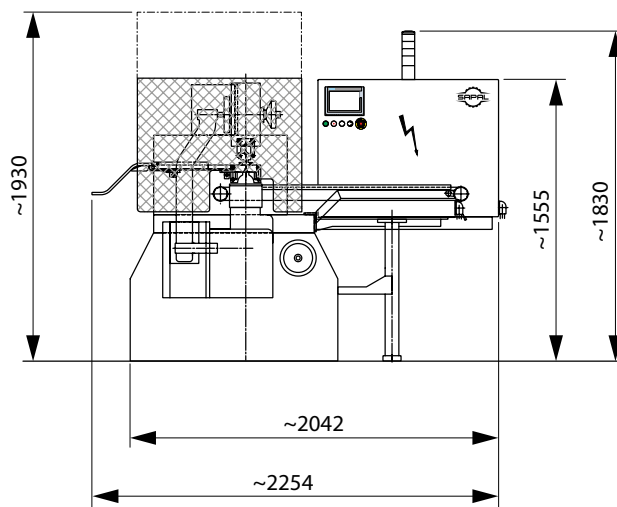

Technical information is subject to change without notice.



**SAPAL SA**

Av. du Tir-Fédéral 44 - 1024 Ecublens - SWITZERLAND - Phone +41 (0)21 633 53 00 - Fax +41 (0)21 633 52 11 - info@sapal.ch - www.sapal.ch